

ASSEMBLY AND INSTALLATION INSTRUCTIONS

W0120 / W0121

WARNING: TO AVOID RISK OF ELECTRICAL SHOCK, BE SURE TO SHUT OFF POWER WHILE INSTALLING OR SERVICING THIS FIXTURE.

NOTES: 1. Before installing, consult local electrical codes for wiring and grounding requirements.
2. READ AND SAVE THESE INSTRUCTIONS.

Hardware Package (included):



Mounting Strap (A)



Washer (B)



Hex Nut (C)



Mounting Screw (D)



Threaded Pipe (E)



Wire Nut (F)



Green Grounding Screw (G)



Ball Nut (H)

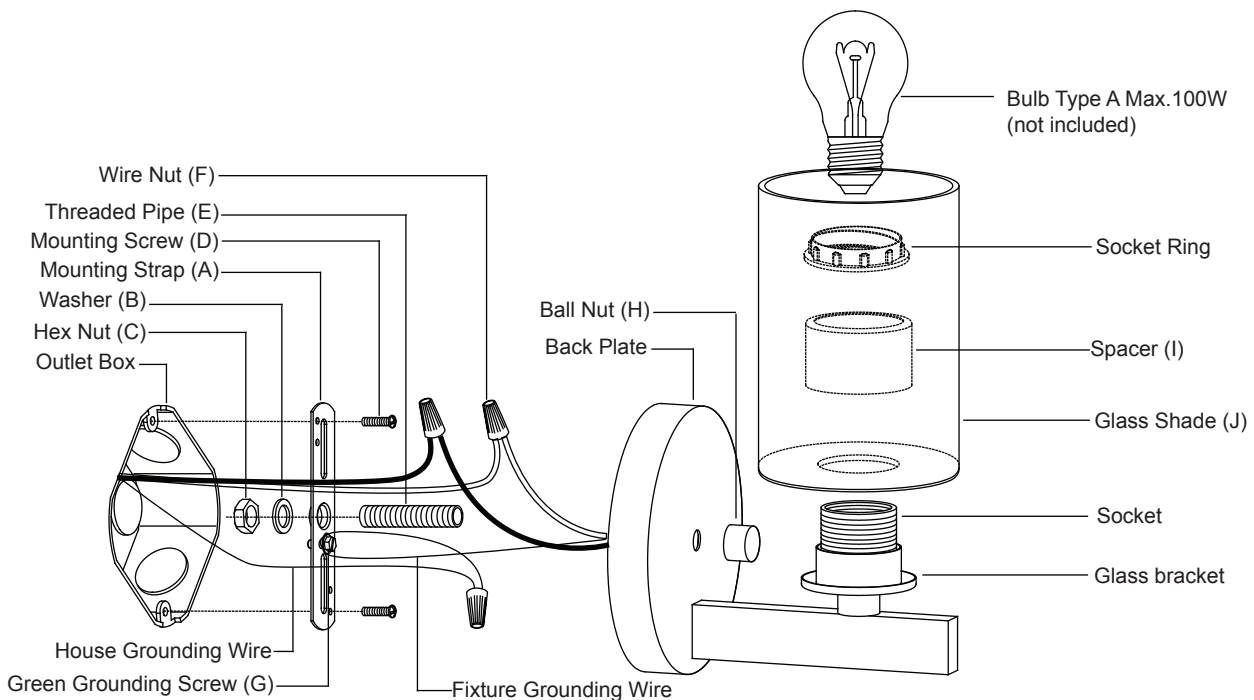

Assembly Instructions:

Turn off the power at fuse or circuit box.

1. Attach the threaded pipe to the mounting strap, then secure it with a washer and hex nut.
2. Attach the mounting strap to outlet box by using two mounting screws.
3. Pull out the source wires from the outlet box. Make wire connections using wire nuts as follows:
 - Connect the hot wire (usually black insulation) from the fixture to the black wire from the power source.
 - Connect the neutral wire (usually white insulation) from the fixture to the white wire from the power source.
 - Attach the fixture grounding wire (usually bare wire) to the mounting strap with the green grounding screw. Then connect it to the house grounding wire with a wire nut. If your outlet box does not have a house grounding wire, then wrap the fixture grounding wire around the green grounding screw.Carefully tuck the wires back into the outlet box.

4. Attach the back plate to the mounting strap: insert the threaded pipe through hole in the back plate, then secure by tightening ball nut.
5. Place the glass shade onto the glass bracket, then secure using a spacer and socket ring.
6. Install bulb (not included). See relamping label at socket area or packaging for maximum allowed wattage.

Turn on the power at the main fuse or circuit breaker box.

The following parts are available for re-order if damaged or missing.

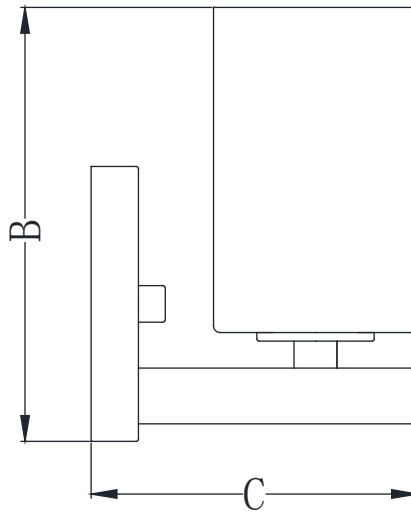
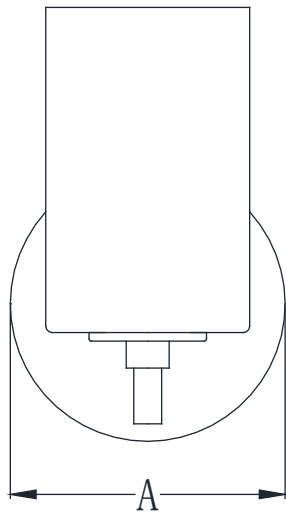
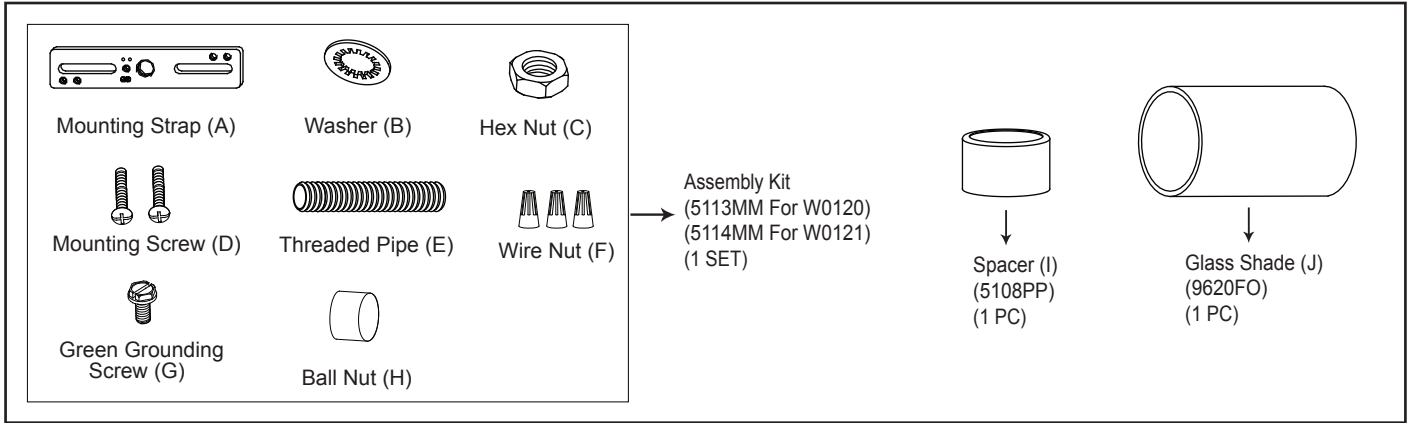

A: 5"
B: 8"
C: 6"